

City of Auburn

Local Landmark
Designation Application

For Staff Use Only			
<input type="checkbox"/> Building	<input type="checkbox"/> Site	<input type="checkbox"/> District	Approval Date _____
<input type="checkbox"/> Structure	<input type="checkbox"/> Object	<input type="checkbox"/> Multiple Property	_____

1. NAME AND LOCATION OF PROPERTY

Historic Name _____
Other names/site number _____
Address 917 Central
Historic address _____

2. PROPERTY OWNER(S) NAME AND ADDRESS

Name Bohl Plumbing & Heating Inc
Street and number 1113 Central Ave
City Nebraska City State NE Zip 68305
Phone (H) _____ (w) (402) 873-5632 Email _____

3. NOMINATION PREPARED BY

Name/title Sarah Atkinson
Organization Peru State College
Street and number _____
City _____ State _____ Zip _____
Phone _____ Email _____
Date prepared 4/13/13 Signature 

Name of Property _____

4. NUMBER OF RESOURCES WITHIN PROPERTY

Contributing	Non Contributing		Contributing resources previously listed on the National Register or Local Register
1		Buildings	
		Sites	None
		Structures	
		Objects	
1		Total	

5. GEOGRAPHIC DATA

Acreeage of property _____

Property identification number 640033954

6. BOUNDARY DESCRIPTION AND JUSTIFICATION

Describe boundary line encompassing all man-made and natural resources to be included in designation (general legal description or survey). Attach map delimiting proposed boundary. (Use continuation sheet if necessary)

Howe & Nixon addition to Asburn Block 20 Lot 9

7. FUNCTION OR USE

Historic Functions	Current Functions
<i>Restaurant</i>	<i>Retail Store</i>

8. DESCRIPTION

Architectural Classification	Materials
	<i>Brick</i>

Narrative Description

On one or more continuation sheets describe the historic and existing condition of the property. Illustrate the following information: original location and setting; natural features; pre-historic man-made features; subdivision design; description of surrounding buildings; major alterations and present appearance; interior appearance.

Name of Property _____

9. STATEMENT OF SIGNIFICANCE

Criteria for Significance

(mark one or more boxes for the appropriate criteria)

- (1) Historical importance or cultural significance, or association with a significant person
- (2) Architectural and engineering importance
- (3) Geographic importance
- (4) Archeological importance

Area(s) of Significance

(See Attachment A for list of categories)

Period of Significance

Significant Dates

1900

Significant Person(s)

Cultural Affiliation/Historic Period

Builder

Architect

Narrative Statement of Significance

Explain the significance of the property as it relates to the above criteria and information on one or more continuation sheets. Include biographical data on significant person(s), builder, and architect, if known.

10. MAJOR BIBLIOGRAPHICAL REFERENCES

Cite the books, articles, and other sources used in preparing this form on one or more continuation sheets.

ATTACHMENT A – Areas of Significance for Local Landmark Designation

A particular site, structure, or area may be designated for preservation as a landmark or historical district if it has:

- (1) Historical importance or cultural significance, or association with a significant person
 - Historical importance or cultural significance, interest or value as part of the development, history, heritage or culture of the City, state or nation;
 - Associated with the life of a person significant in the past;
 - Site of an historic event, or exemplifies the cultural, political, economic, educational, social or historic heritage of the community;

- (2) Architectural and engineering importance
 - Architectural and engineering importance, portraying the historical setting or environment of a distinctive characteristic of an architectural or engineering type, period, style, or method of construction;
 - Work of a resident, builder or designer whose individual work is significant in the development of the City;
 - Contains elements of design, detail, materials or craftsmanship of distinctive quality, or which represents a significant innovation;

- (3) Geographic importance
 - Geographic importance, by being a part of or related to a city center, park or other distinctive area, which should be developed or preserved according to a plan based on a historic, cultural or architectural motif;
 - Owing to its unique location or singular physical characteristic, represents an established and familiar visual feature of a neighborhood, community, or the City; or

- (4) Archeological importance has yielded or is likely to yield information regarding the history of the area prior to the establishment of the City.

Continuation Sheet

Section 8 Page 1

This building, located at 917 Central Ave (also known as Hwy 36). It was built in 1900 and the façade still shows the decorative stone moulding of the time period on the second story of the building. The first story's façade was modernized during the 1960s.

This building shares walls with the buildings on both the east and west sides.

The front only features an entrance to the first story. There is a stairway in back of the building that leads to the apartments on the second story.

Continuation

Section 9 Page 1

Since its construction in 1900, this building has been a part of the downtown business area of Auburn. For the last 113 years, several businesses have occupied the space and served the community of Auburn and the surrounding rural area.

Known businesses that have occupied this space include the Dustin Candy Kitchen (1930 through a least the 1950s) and The Waterhole tavern (1982).

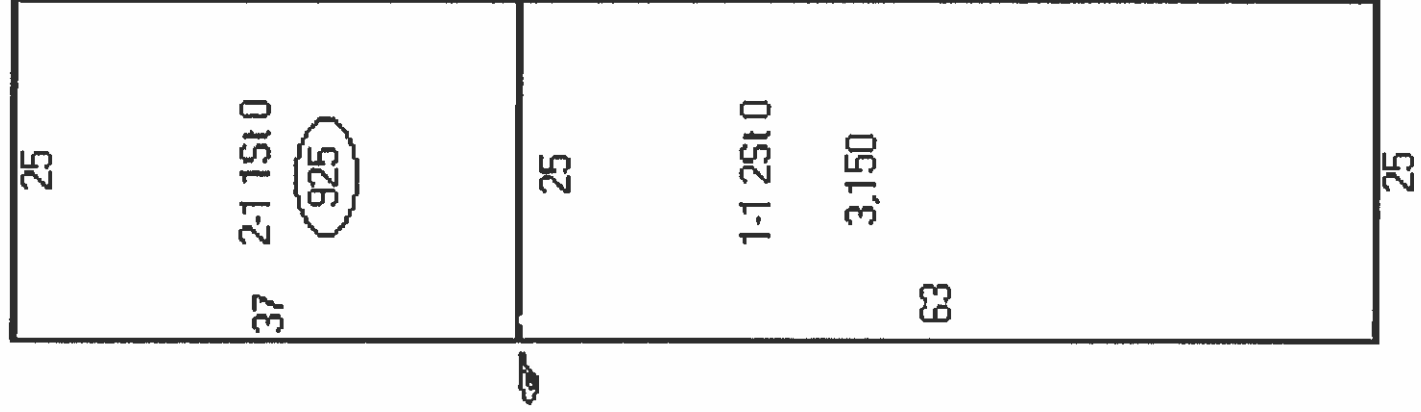

iron wall.

Continuation

Section 10 Page 1

Bibliography

Auburn Directory. Years 1930, 1954-1961, 1982. Auburn: Nemaha County Museum. 13 March 2013 and 10 Apr 2013.

Barnhart, E.G. Auburn: A progressive, Wide Awake City of the Great Mid-West. Auburn, NE: Herald Printing House, Date Unknown. Print.

Engles, Margaret. Personal Interview. Auburn: 14 Apr 2013.

Hemmingsen, Robert. Personal Interview. Auburn: 25 Feb 2013.

***Nemaha County Assessor.* Nemaha County Assessor. Web. 13 April 2013**

Nemaha County Museum Archives. Undated photographs. 10 Apr 2013.

Nemaha County Register of Deeds. Misc. public records. 12 Apr 2013.

917 Central

Long Time home of The Candy Kitchen

